

ADULT AND PEDIATRIC APPLICATION GUIDE

Nellcor™ SpO₂ Adhesive Sensor



MAXA



MAXP



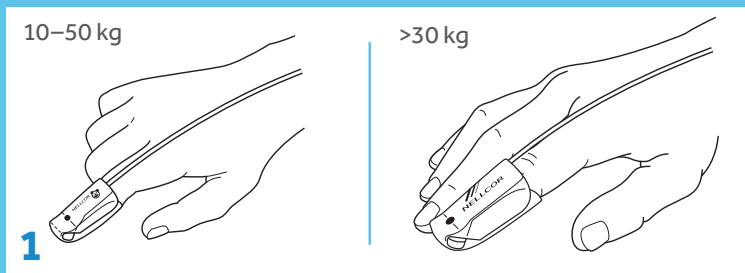

An index finger is the preferred sensor site. Alternatively, apply the sensor to a smaller finger, thumb, or big toe. Use the pediatric sensor for pediatric patients weighing 10–50 kg. Use the adult sensor for adults weighing more than 30 kg.

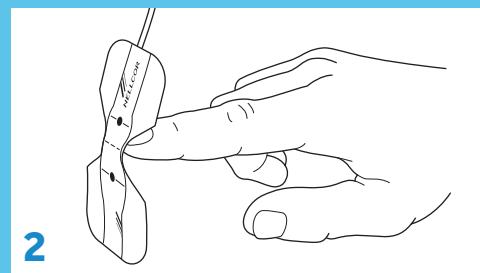

Remove the transparent backing from the sensor. Locate window and alignment marks. Orient the sensor so the dashed line is centered on the tip of the finger and the windows oppose each other.

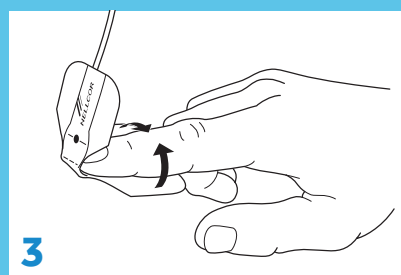

Apply the noncable half of the sensor to the bottom of the finger, and wrap the adhesive flaps around the sides of the finger.

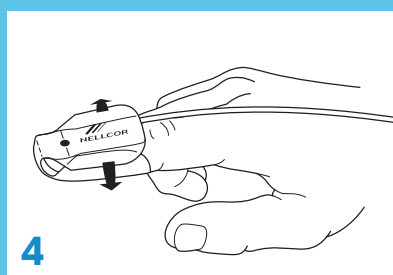

Fold the cable end of the sensor over the top of the finger. Wrap the adhesive flaps around the sides of the finger.

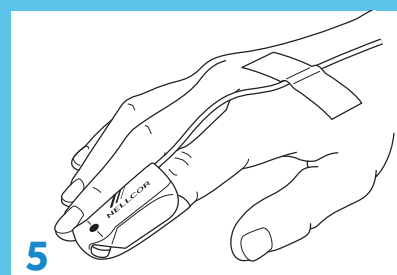

Anchor the sensor cable with a piece of medical-grade tape. Plug the connector end of the sensor cable into the patient cable attached to the monitor.

Check sensor site, including skin integrity, at least every eight hours, and change the sensor site as appropriate.

If you have any questions, contact your Medtronic product representative at 800-635-5267.



Read the sensor's "Directions for Use" insert for complete instructions for use, including all warnings, cautions, and specifications, prior to use of this product.

©2017 Medtronic. All rights reserved. Medtronic, Medtronic logo and Further, Together are trademarks of Medtronic. All other brands are trademarks of a Medtronic company. 03/2017-12-PM-0109(1)-[WF#1537372]

6135 Gunbarrel Avenue
Boulder, CO 80301

800.635.5267

medtronic.com/covidien

Medtronic